

# RMC-3S-0

## Applications

Internet Server (Web / Mail)

File Server

NAS/iSCSI

CCTV Surveillance DVR

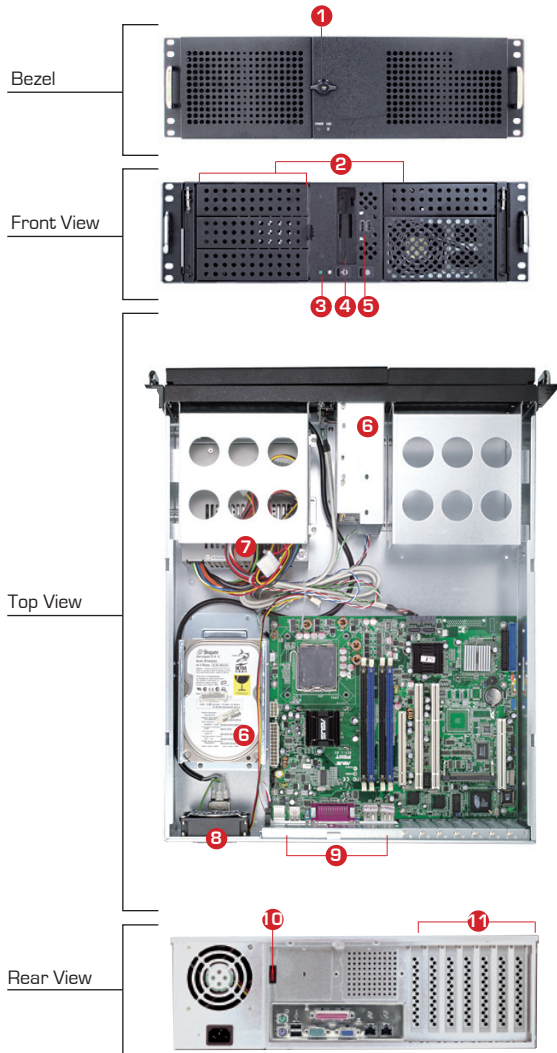

## Features & Benefits

- 1 Front bezel with lock for data security and protection
- 2 Four(4) external 5.25-inch optical bays supported
- 3 Power on/off, system reset and LEDs for HDD & LAN
- 4 One(1) external 3.5-inch optical bay supported
- 5 Front access dual USB port
- 6 Four(4) internal 3.5-inch HDD supported
- 7 PS/2 size single power supply
- 8 One(1) easy-swap rear fan for optimized cooling
- 9 Two(2) rear fan slots for upgrade
- 10 Rear access power supply alarm reset
- 11 Seven(7) PCI slots attribute to network expansion and scalability

**BTO** Built-to-Order (BTO) : Minimum Order Quantity (MOQ) 100

Model Number : RMC-3S-0

Order Information : RMC-3S-0

Industry Standard : EIA-RS310D

Materials : Heavy-duty preplated SPGC cold-rolled steel

Finish : Inside / Body : NA  
Outside / Front : Texture coated on front panel

Dimensions : mm : 482.6 x 530 x 133.35  
(W x D x H) inches : 19 x 21 x 5.25

Cooling : Rear: 1 x 80x25mm fan  
(+ optional 2 x 60x25mm - order as module)

● Descriptions	
Power Supply : 30X	300W ATX PFC
46E	460W EPS-12V PFC

Expansion : 7 x PCI slots (full height, full length)

Controls : Power on/off and system reset + 2 x USB ports

Indicators : Power and HDD LEDs

System Board : Up to 12"(W) x 10.5"(D) ATX/SSI CEB compliant M/B

Drive Bay :		5.25"	4
External	3.5"	1	
	3.5" hot-swap	0	
	2.5" hot-swap	0	
	Internal	3.5"	4
Slim CD-Rom/DVD-Rom		0	
Slim FDD		0	

Temperature : 0°C(32°F) ~ 50°C(122°F)

Humidity : 5%~95% non-condensing

Gross Weight : 15 kgs / 33 lbs

Packaging Dimension (W x D x H) : mm : 580 x 710 x 300

Cubic Feet : 4.4

Reference Container Loading :	20'	238
	40'	477
	40' H	545

Mounting Options :	BKT-2M-010-04400-G	BKT-2S-010-24200-F
	SLR-20	SLR-26

## Mechanical Drawing

